



Fortress
Diagnostics

Coronavirus Ag Rapid Test

The novel coronaviruses belong to the β genus. COVID-19 is an acute respiratory infectious disease. People are generally susceptible. Currently, the patients infected by the novel coronavirus are the main source of infection; asymptomatic infected people can also be an infectious source. Based on the current epidemiological investigation, the incubation period is 1 to 14 days, mostly 3 to 7 days. The main manifestations include fever, fatigue and dry cough. Nasal congestion, runny nose, sore throat, myalgia and diarrhoea are found in a few cases.

Antigen is generally detectable in upper respiratory specimens during the acute phase of infection. Rapid diagnosis of SARS-CoV-2 infection will help healthcare professionals to treat patients and control the disease more efficiently and effectively.

Product Information

The Coronavirus Ag Rapid Test Cassette (Swab) is an in vitro immunochromatographic assay for the qualitative detection of nucleocapsid protein antigen from SARS-CoV-2 in nasopharyngeal (NP) swab specimens directly from individuals who are suspected of COVID-19 by their healthcare provider. It is intended to aid in the rapid diagnosis of SARS-CoV-2 infections. The Coronavirus Ag Rapid Test Cassette (Swab) does not differentiate between SARS-CoV and SARS-CoV-2.

Benefits

- **Rapid testing for SARS-CoV-2 antigen within 15 minutes**
- **Facilitates patient treatment decisions quickly**
- **Simple, time-saving procedure**
- **All necessary reagents provided & no equipment needed**
- **High sensitivity and specificity**

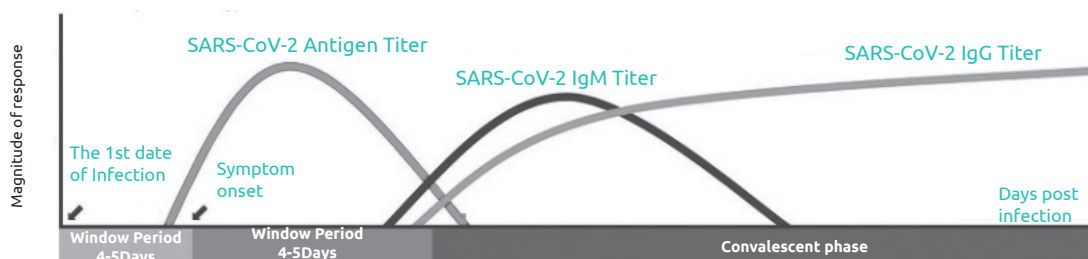

CE QUALITY MANAGEMENT SYSTEM
ISO 13485 CERTIFIED COMPANY





Specification

Information	Detail
Result time	15 minutes
Storage	2-30°C
Shelf Life	24 Months
Specimen Type	Nasopharyngeal swab

Contents

Test cassettes
Sterile swabs
Extraction tubes and filtered nozzles
Tube Rack
Buffers
Instruction for Use

Performance Characteristics

The Coronavirus Ag Rapid Test Cassette (Swab) has been evaluated with specimens obtained from patients. A commercialized molecular assay was used as the reference method. The results show that the Coronavirus Ag Rapid Test Cassette (Swab) has a high overall relative accuracy.

Method		PCR		Total Results
Coronavirus Ag Rapid Test Cassette	Results	Positive	Negative	
	Positive	59	2	61
	Negative	2	254	256
Total Results		61	256	317

Relative Sensitivity: 96.2%

Relative Specificity: 99.22%

Accuracy: 98.74%

Test Procedure & Interpretation

Specimen collection

Use the nasopharyngeal swab supplied in the kit.

1. Carefully insert the swab into the nostril of the patient, reaching the surface of posterior nasopharynx that presents the most secretion under visual inspection.
2. Swab over the surface of the posterior nasopharynx. Rotate the swab several times.
3. Withdraw the swab from the nasal cavity.



CE QUALITY MANAGEMENT SYSTEM
ISO 13485 CERTIFIED COMPANY



T 01782 575180 | E info@unahealth.co.uk | W www.unahealth.co.uk
Unit 3, Fitzgerald Way, Scotia Road Business Park, Stoke-on-Trent, ST6 4HN



Sample preparation

1. Insert the test extraction tube into the workstation in this product. Make sure that the tube is standing firm and reaches the bottom of the workstation.
2. Add 0.3 mL (about 10 drops) of the sample extraction buffer into the extraction tube.

Performance Characteristics

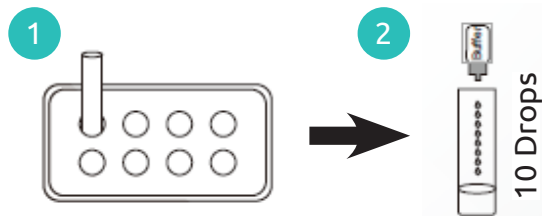

3. Insert the swab into the extraction tube which contains 0.3 mL of the extraction buffer.
4. Rotate the swab at least 6 times while pressing the head against the bottom and side of the extraction tube.
5. Leave the swab in the extraction tube for 1 minute.
6. Squeeze the tube several times with fingers from outside of the tube to immerse the swab. Remove the swab.
7. Insert the filtered nozzle provided into the extraction tube tightly.

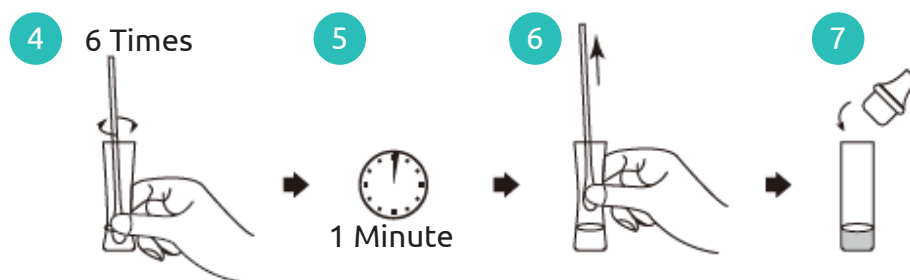

Test procedure & Interpretation of results



Ordering Information

Catalogue Number	Description	Quantity
COVAG010	Coronavirus Ag Rapid Test	10 TESTS
COVAG020	Coronavirus Ag Rapid Test	20 TESTS

Cost is dependant on quantity and location of shipping.
 A lead time of 4 weeks from placing your order can be expected and all orders must be paid in advance.
 For more information please email covid19@fortressdiagnostics.com

CE QUALITY MANAGEMENT SYSTEM
 ISO 13485 CERTIFIED COMPANY



T 01782 575180 | E info@unahealth.co.uk | W www.unahealth.co.uk
 Unit 3, Fitzgerald Way, Scotia Road Business Park, Stoke-on-Trent, ST6 4HN